

MAGNUM VENUS PLASTECH

Assy - C32 Catalyst Pump

VHPC-3200-C-UPS

REV. B - ITEM 31 WAS 0-S-011 03/09/06 BT2
 REV. C - CHANGED ITEM 16 TO INCLUDE ITEM 1 2/21/07 JEM
 REV. D - ADDED THREADLOCKER NOTE 05/15/08 BT2
 REV. E - ADDED ITEM 4 11/23/13 BT2

COMMON ASSY PARTS LIST

ITEM	PART NO.	QTY	DESCRIPTION
2	50370-1	1	PISTON ROD
3	50620-1	1	PACKING NUT
4	50591-1	1	PISTON ROD SLEEVE
* 5	02021-1	1	PACKING SET ASSY
6	50710-1	1	OUTLET BODY
7	50810-1	1	LOCK NUT
* 8	O-S-022	2	O-RING
9	50960-1	1	CYLINDER
10	04009-1	1	PISTON SPRING
11	03021	1	5/16" SS BALL
12	50420-1	1	PISTON BODY
* 13	02013	1	PISTON SEAL
14	50520-1	1	SEAL RETAINER
15	03071	1	7/8" SS BALL
16	51040-3	1	INLET BODY ASSY
* 17	O-S-013	3	O-RING
19	VHPC-3201	1	CLEVIS
25	VHPC-1003	1	INLET FITTING
26	MS-2053	1	ELBOW
28	CV-2002	1	SPRING HOUSING
29	CV-2004	1	SPRING
30	CV-2003	1	PISTON
* 31	O-S-011A	1	O-RING
32	CV-2001	1	SEAT HOUSING
33	51501-1	1	OUTLET FITTING
	6701-24-EN	1	PUMP SEAL WARNING DECAL (NOT SHOWN)

REPAIR KITS

PART NO.	DESCRIPTION
* VHPC-3200-SK	SEAL KIT

OPTIONAL PARTS & ASSEMBLIES

ITEM	PART NO.	QTY	DESCRIPTION
1	9202-1-1	1	SPHERICAL BEARING
34	CV-2000	1	CHECK VALVE

FIGURE 1-1

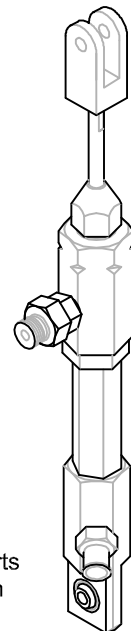

Note:
Offset intake and outlet ports
one flat on hex as shown in
figure 1-1