

# MAGNUM VENUS PLASTECH

Catalyst Pump Assy (W/Check Valve)  
 Catalyst Pump Assy (For Relief Valve)  
 Catalyst Pump Assy (W/Check Valve)  
 Catalyst Pump Assy (W/Check Valve)

VHPC-2000  
 VHPC-2000-RV  
 VHPC-2000-C-3J  
 VHPC-2000-C-UPS

REV. G = ITEM 25 WAS PF-HN-02-03J-SS, ITEM 38 WAS O-S-011 02/23/06 BT2  
 REV. H = ADDED ITEM 26 04/14/06 BT2  
 REV. I = ADDED THREADLOCKER NOTE 05/15/08 BT2  
 REV. J = REINSTITUTED THE VHPC-2000 11/08/12 BT2

Catalyst Pump Assy VHPC-2000  
 Catalyst Pump Assy VHPC-2000-RV  
 Catalyst Pump Assy VHPC-2000-C-3J  
 Catalyst Pump Assy VHPC-2000-C-UPS

**COMMON ASSY PARTS LIST**

ITEM	PART NO.	QTY	DESCRIPTION
1	4101-14-1	1	OUTLET BODY
2	4101-2-1	1	CYLINDER
3	4101-7-1	1	INLET BODY
4	4101-11-1	1	PACKING NUT
5	4101-9-1	1	CLEVIS
6	4101-10-1	1	PISTON ROD
* 7	4101-12-1	1	UPPER GUIDE
* 8	4101-13-01	1	ROD PACK SPA
11	4101-4-1	1	PISTON BODY
* 12	7304-2-1	1	PISTON SEAL
* 13	4101-5-1	1	PISTON GUIDE
14	4101-6-1	1	SEAL RETAINER
15	9202-1-1	1	SPHERICAL BEARING
* 16	O-S-013	3	O-RING
* 17	O-S-014	2	O-RING
* 18	4101-3-1	1	PISTON ROD SPRING
* 19	9201-1-5	1	5/32" SS BALL
* 20	9201-1-14	1	7/16" SS BALL
21	4101-1-1	1	LOCK NUT
26	6701-24-EN	1	WARNING DECAL
35	CV-2002	1	SPRING HOUSING
36	CV-2004	1	SPRING
37	CV-2003	1	PISTON
* 38	O-S-011A	1	O-RING
39	CV-2001	1	SEAT HOUSING

**ASSOCIATED PARTS AND ASSEMBLIES**

22	4101-7-01	1	INLET BODY ASSEMBLY
40	CV-2000	1	CHECK VALVE ASSEMBLY

**REPAIR KITS**

PART NO.	DESCRIPTION
* VHPC-2000-RK	REPAIR KIT

**Catalyst Pump Assy VHPC-2000**

**PARTS LIST**

ITEM	PART NO.	QTY	DESCRIPTION
9	51700-1	1	OUTLET FITTING
10	4101-8-1	1	TUBE FITTING

**Catalyst Pump Assy VHPC-2000-RV**

**PARTS LIST**

ITEM	PART NO.	QTY	DESCRIPTION
10	4101-8-1	1	TUBE FITTING
24	RV-1021	1	ADAPTER
25	PF-HN-02-04S-SS	1	OUTLET FITTING
29	4101-18-1	1	JAM NUT

**Catalyst Pump Assy VHPC-2000-C-3J**

**PARTS LIST**

ITEM	PART NO.	QTY	DESCRIPTION
10	4101-8-1	1	TUBE FITTING
23	51501-1	1	OUTLET FITTING

**Catalyst Pump Assy VHPC-2000-C-UPS**

**PARTS LIST**

ITEM	PART NO.	QTY	DESCRIPTION
23	51501-1	1	OUTLET FITTING
33	VHPC-1003	1	INLET FITTING
34	MS-2053	1	ELBOW

**FIGURE 1-1**

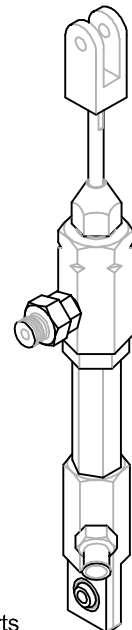

Note:  
 Offset intake and outlet ports  
 one flat on hex as shown in  
 figure 1-1