

REVISION HISTORY			
REV	DESCRIPTION	DATE	APPROVED
-	INITIAL RELEASE		
A	ADDED 2) 07246, ADDED F-HB-08C-16, F-FW-08 AND F-HN-08C	10/3/2019	BT2

<p>MVP MAGNUM VENUS PRODUCTS</p> <p>CORPORATE HEADQUARTERS TECHNOLOGY CENTER 10535 Hardin Valley Road Knoxville, TN 37932 865.686.5670</p> <p>1962 Ives Avenue Kent, WA 98032 253.854.2660</p> <p>***CONFIDENTIAL*** This document contains proprietary information that is the sole property of MVP. Distribution, reproduction, disclosure or use by others, in part or in whole, is not permitted without prior written permission of MVP and all rights herein reserved.</p>	<p>TOLERANCES UNLESS OTHERWISE SPECIFIED ALL DIMENSIONS ARE IN INCHES</p> <table border="0"> <tr> <td>DECIMALS</td> <td>FRACTIONS</td> </tr> <tr> <td>.XX ± 0.10</td> <td>XX ± 1/32"</td> </tr> <tr> <td>.XXX ± .003</td> <td>ANGULAR</td> </tr> <tr> <td>TIR ± .005</td> <td>XX° ± 1/2"</td> </tr> </table>		DECIMALS	FRACTIONS	.XX ± 0.10	XX ± 1/32"	.XXX ± .003	ANGULAR	TIR ± .005	XX° ± 1/2"	<p>SPECIFICATION ASSEMBLY</p>	
	DECIMALS	FRACTIONS										
	.XX ± 0.10	XX ± 1/32"										
	.XXX ± .003	ANGULAR										
TIR ± .005	XX° ± 1/2"											
<p>*DO NOT SCALE DRAWING* ALL DIMENSIONS APPLY AFTER FINISH BREAK SHARP EDGES .005 MAX RADI .005 X 45° MAX CHAMFER</p>		<p>DESIGNED BSTAPLETON</p> <p>DRAWN BSTAPLETON</p> <p>DATE 12/2/2016</p>										
		<p>DESCRIPTION SINGLE RAM CONTROL PANEL, ADD ON UNIT</p>										
		<p>PROJECT</p>										
<table border="1"> <tr> <td>NEXT</td> <td>FINAL</td> <td>NEXT ASSY</td> <td>FINAL ASSY</td> </tr> <tr> <td> </td> <td> </td> <td> </td> <td> </td> </tr> </table>		NEXT	FINAL	NEXT ASSY	FINAL ASSY					<p>DWG NO PCN-RAM-2</p>		
NEXT	FINAL	NEXT ASSY	FINAL ASSY									
<p>QTY PER ASSY</p>		<p>WHERE USED</p>										
		<p>SHEET 1 OF 6</p>										
		<p>REV A</p>										

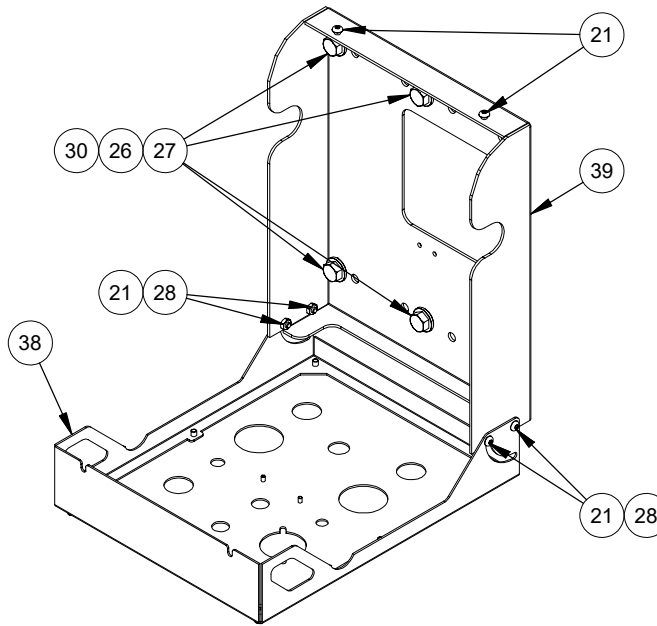
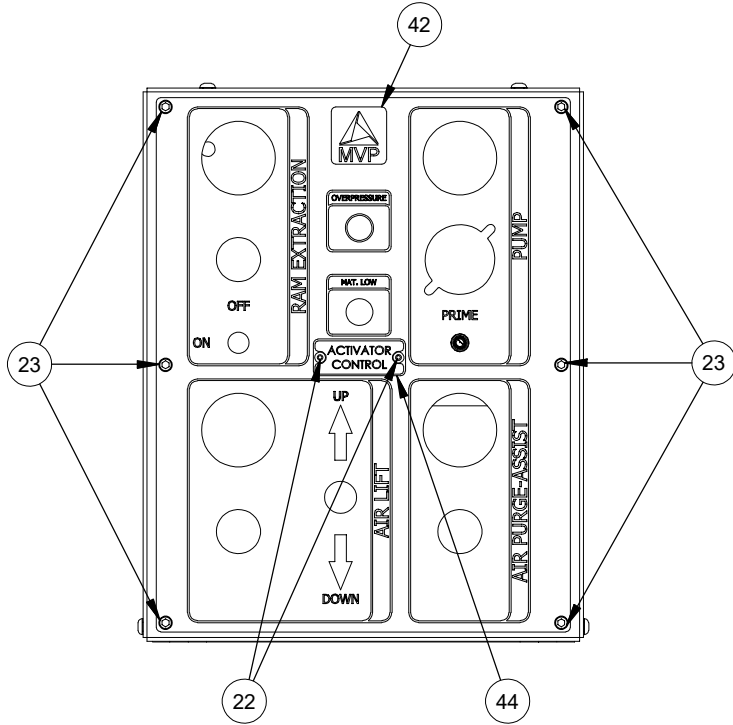

NOTES:

APPLY LOCTITE TO ALL FASTENERS EXCEPT MOUNTING U BOLTS

QTY	ITEM	PART NUMBER	DESCRIPTION
1	44	PCN-1008	ACTIVATOR BADGE
1	42	PCN-1006	LASER ETCHED PANEL FACE
1	39	PCN-1002	PANEL BACK PLATE
1	38	PCN-1001	PANEL FRONT
4	30	F-HN-08C	HEX NUT
4	28	F-HN-04C	HEX NUT
4	27	F-HB-08C-16	HEX BOLT
8	26	F-FW-08	FLAT WASHER
6	23	F-CS-04C-06	SOCKET HEAD CAP SCREW
2	22	F-BHCS-832-06	BUTTON HEAD CAP SCREW
6	21	F-BHCS-04C-08	BUTTON HEAD CAP SCREW

Parts List

<p>CORPORATE HEADQUARTERS TECHNOLOGY CENTER 10535 Hardin Valley Road, Knoxville, TN 37932, 865.686.5670 1362 Ives Avenue, Kent, WA 98032, 253.854.2660</p> <p>***CONFIDENTIAL*** This document contains proprietary information that is the sole property of MVP. Distribution, reproduction, disclosure or use by others, in part or in whole, is not permitted without prior written permission of MVP and all rights herein reserved.</p>	<p>TOLERANCES UNLESS OTHERWISE SPECIFIED ALL DIMENSIONS ARE IN INCHES</p> <p>DECIMALS: .XX ± 0.10, .XXX ± .003, TIR ± .005 FRACTIONS: XX ± 1/32", ANGULAR XX° ± 1/2"</p> <p>"DO NOT SCALE DRAWING" ALL DIMENSIONS APPLY AFTER FINISH BREAK SHARP EDGES .005 MAX RADII .005 X 45° MAX CHAMFER</p>		<p>SPECIFICATION ASSEMBLY</p> <p>DESIGNED: BSTAPLETON, DRAWN: BSTAPLETON, DATE: 12/2/2016</p> <p>DESCRIPTION: SINGLE RAM CONTROL PANEL, ADD ON UNIT</p>	
	<p>PROJECT: _____</p>		<p>DWG NO: PCN-RAM-2</p>	
	<p>QTY PER ASSY: _____</p>		<p>WHERE USED: _____</p>	
	<p>PROJECT: _____</p>		<p>SHEET: 2 OF 6, REV: A</p>	

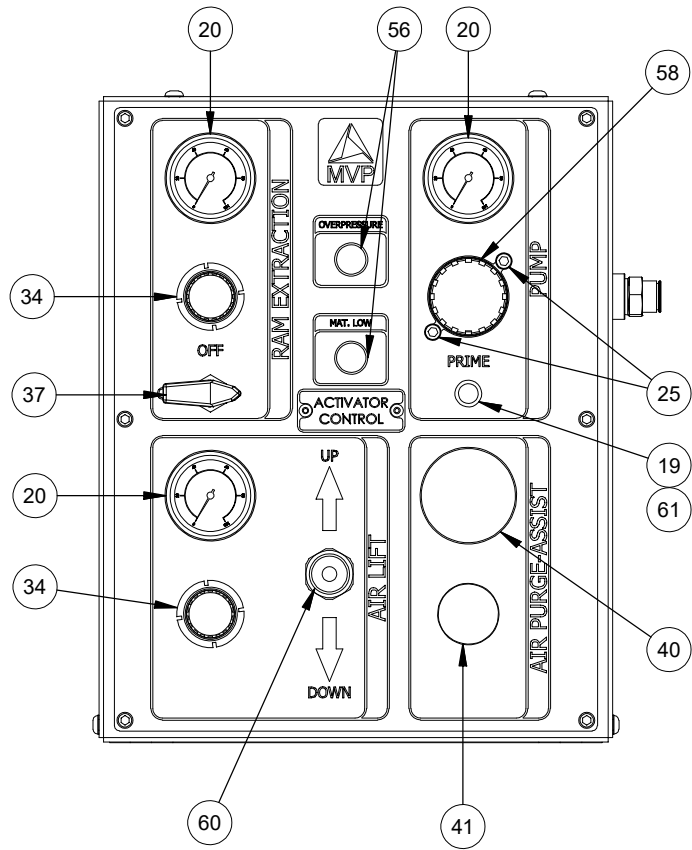

REVISION HISTORY			
REV	DESCRIPTION	DATE	APPROVED
-	INITIAL RELEASE		
A	ADDED 2) 07246, ADDED F-HB-08C-16, F-FW-08 AND F-HN-08C	10/3/2019	BT2

QTY	ITEM	PART NUMBER	DESCRIPTION
1	61	PNE-VPN-101	PANEL NUT
1	60	PNE-TOG-106-3P	LEVER TOGGLE VALVE - 3 POSITION
1	58	PNE-REG-101	REGULATOR
2	56	PNE-IND-102	RED/GREEN INDICATOR
1	41	PCN-1004	ENCLOSURE PLUG
1	40	PCN-1003	ENCLOSURE PLUG
1	37	MRD-1017	BALL VALVE
2	34	INV-CB-RG-1	.250" REGULATOR
2	25	F-CS-M6-16	HEX SOCKET CAP SCREW - Metric
3	20	AG-PM2-100-P	PANEL MOUNT GAUGE
1	19	8407-5-1	PUSH BUTTON

Parts List					
<p>MVP MAGNUM VENUS PRODUCTS CORPORATE HEADQUARTERS TECHNOLOGY CENTER 10535 Hardin Valley Road Knoxville, TN 37932 865.686.5670</p> <p>1862 Ives Avenue Kent, WA 98032 253.854.2660</p> <p>***CONFIDENTIAL*** This document contains proprietary information that is the sole property of MVP. Distribution, reproduction, disclosure or use by others, in part or in whole, is not permitted without prior written permission of MVP and all rights herein reserved.</p>		<p>TOLERANCES UNLESS OTHERWISE SPECIFIED ALL DIMENSIONS ARE IN INCHES</p> <table border="0"> <tr> <td>DECIMALS .XX ± 0.10 .XXX ± .003 TIR ± .005</td> <td>FRACTIONS 1/25 ANGULAR XX' ± 1/2"</td> </tr> </table>		DECIMALS .XX ± 0.10 .XXX ± .003 TIR ± .005	FRACTIONS 1/25 ANGULAR XX' ± 1/2"
		DECIMALS .XX ± 0.10 .XXX ± .003 TIR ± .005	FRACTIONS 1/25 ANGULAR XX' ± 1/2"		
<p>DO NOT SCALE DRAWING* ALL DIMENSIONS APPLY AFTER FINISH BREAK SHARP EDGES .005 MAX RADII .005 X 45° MAX CHAMFER</p>					
<p>SPECIFICATION ASSEMBLY</p>		<p>DESIGNED BSTAPLETON</p>	<p>DATE 12/2/2016</p>		
<p>SINGLE RAM CONTROL PANEL, ADD ON UNIT</p>					
<p>PROJECT</p>		<p>DWG NO</p>			
<p>NEXT FINAL NEXT ASSY FINAL ASSY</p>		<p>SHEET 3 OF 6</p>	<p>REV A</p>		
<p>QTY PER ASSY</p>		<p>WHERE USED</p>			
		<p>PCN-RAM-2</p>			

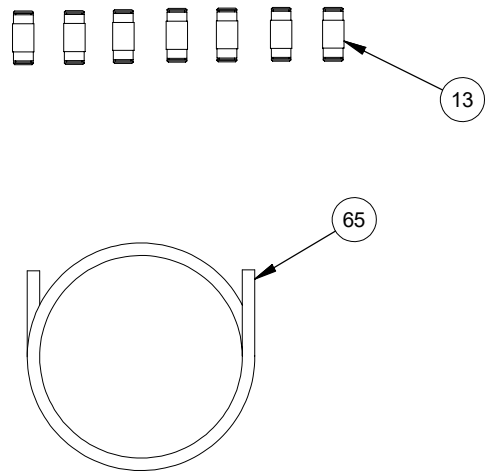
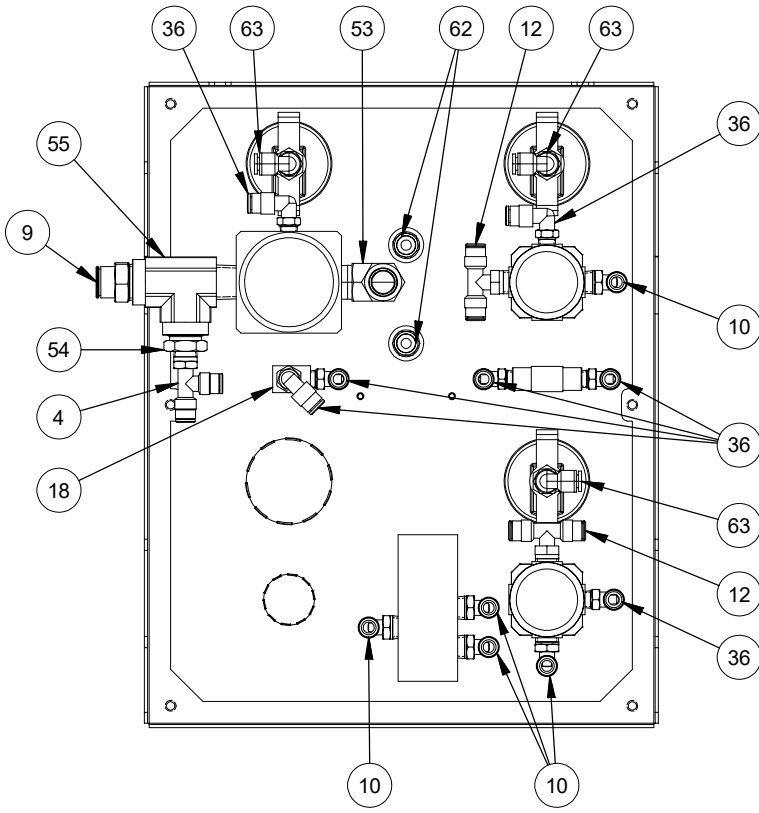

NOTES:
 THREAD TAPE ALL NPT PER STANDARD

1	65	MPM-2052-1	TUBING
3	63	PTF-FE-04-04-PL	.250 FNPT TO .250 TUBE
2	62	PTF-02F-04	FEMALE CONNECTOR
1	55	PF-ST-08	STREET TEE
1	54	PF-RB-08-04	REDUCER BUSHING
1	53	PF-ME-08-06	MALE ELBOW
7	36	MPH-2539	MALE ELBOW
1	18	8407-4-1	3-WAY VALVE
7	13	07246	UNION-POLY
2	12	07238	BRANCH TEE
5	10	07233	MALE POLY ELBOW
1	9	06556	MALE CONNECTOR
1	4	06963	MALE RUN TEE SWIVEL
QTY	ITEM	PART NUMBER	DESCRIPTION

<p>CORPORATE HEADQUARTERS TECHNOLOGY CENTER 10535 Hardin Valley Road Knoxville, TN 37932 865.686.5670</p> <p>1362 Ives Avenue Kent, WA 98032 253.854.2660</p> <p>***CONFIDENTIAL*** This document contains proprietary information that is the sole property of MVP. Distribution, reproduction, disclosure or use by others, in part or in whole, is not permitted without prior written permission of MVP and all rights herein reserved.</p>		<p>TOLERANCES UNLESS OTHERWISE SPECIFIED ALL DIMENSIONS ARE IN INCHES</p> <table border="0"> <tr> <td>DECIMALS .XX ± 0.10 .XXX ± .003 TIR ± .005</td> <td>FRACTIONS 1/25 ANGULAR XX' ± 1/2"</td> </tr> </table>		DECIMALS .XX ± 0.10 .XXX ± .003 TIR ± .005	FRACTIONS 1/25 ANGULAR XX' ± 1/2"	<p>SPECIFICATION ASSEMBLY</p>	
		DECIMALS .XX ± 0.10 .XXX ± .003 TIR ± .005	FRACTIONS 1/25 ANGULAR XX' ± 1/2"				
<p>"DO NOT SCALE DRAWING" ALL DIMENSIONS APPLY AFTER FINISH BREAK SHARP EDGES .005 MAX RADII .005 X 45° MAX CHAMFER</p>		<p>DESIGNED B STAPLETON</p> <p>DRAWN B STAPLETON</p> <p>DATE 12/2/2016</p> <p>DESCRIPTION SINGLE RAM CONTROL PANEL, ADD ON UNIT</p>					
<p>PROJECT</p>		<p>DWG NO</p>					
<p>QTY PER ASSY</p>		<p>WHERE USED</p>					
<p>PCN-RAM-2</p>		<p>SHEET 4 OF 6</p>					
<p>REV A</p>							

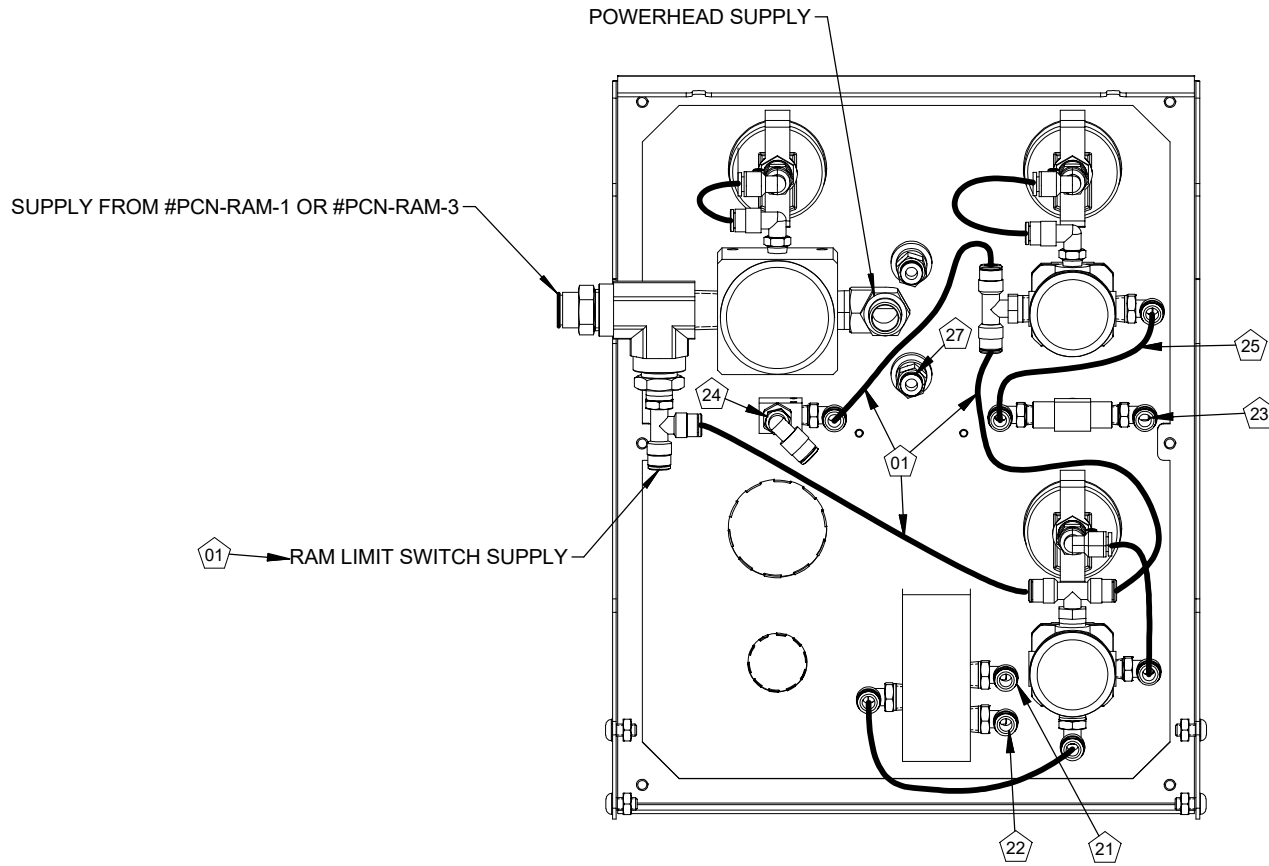

- NOTES:**
1. ALL NUMBERS AND SYMBOLS CORRESPOND WITH PNEUMATIC SCHEMATIC #PCN-RAM-2.
 2. ATTACH 18" LONG OUTLET LINES TO REMAINING OPEN 1/4" POLYLINE CONNECTORS AND PORTS (TUBE #PUT-04-TB-1)
 3. ADD UNION #07246 TO END OF 18" LONG OUTLET LINES.

MVP
MAGNUM VENUS PRODUCTS
CORPORATE HEADQUARTERS TECHNOLOGY CENTER
10535 Hardin Valley Road Knoxville, TN 37932 865.686.5670
1962 Ives Avenue Kent, WA 98032 253.854.2660

*****CONFIDENTIAL*****
This document contains proprietary information that is the sole property of MVP. Distribution, reproduction, disclosure or use by others, in part or in whole, is not permitted without prior written permission of MVP and all rights herein reserved.

TOLERANCES UNLESS OTHERWISE SPECIFIED ALL DIMENSIONS ARE IN INCHES		SPECIFICATION ASSEMBLY	
DECIMALS .XX ± 0.10 .XXX ± .003 TIR ± .005	FRACTIONS 12/32 ANGULAR XX° ± 1/2"	DESIGNED BSTAPLETON	DATE 12/2/2016
DO NOT SCALE DRAWING ALL DIMENSIONS APPLY AFTER FINISH BREAK SHARP EDGES .005 MAX RADI .005 X 45° MAX CHAMFER		DESCRIPTION SINGLE RAM CONTROL PANEL, ADD ON UNIT	
PROJECT		DWG NO PCN-RAM-2	
NEXT FINAL	NEXT ASSY FINAL ASSY	SHEET 5 OF 6	REV A
QTY PER ASSY	WHERE USED		

