

ATC-4000-4H-CK FOUR HOSE CONVERSION KIT FOR ATC-4000

01-02-01 BT2

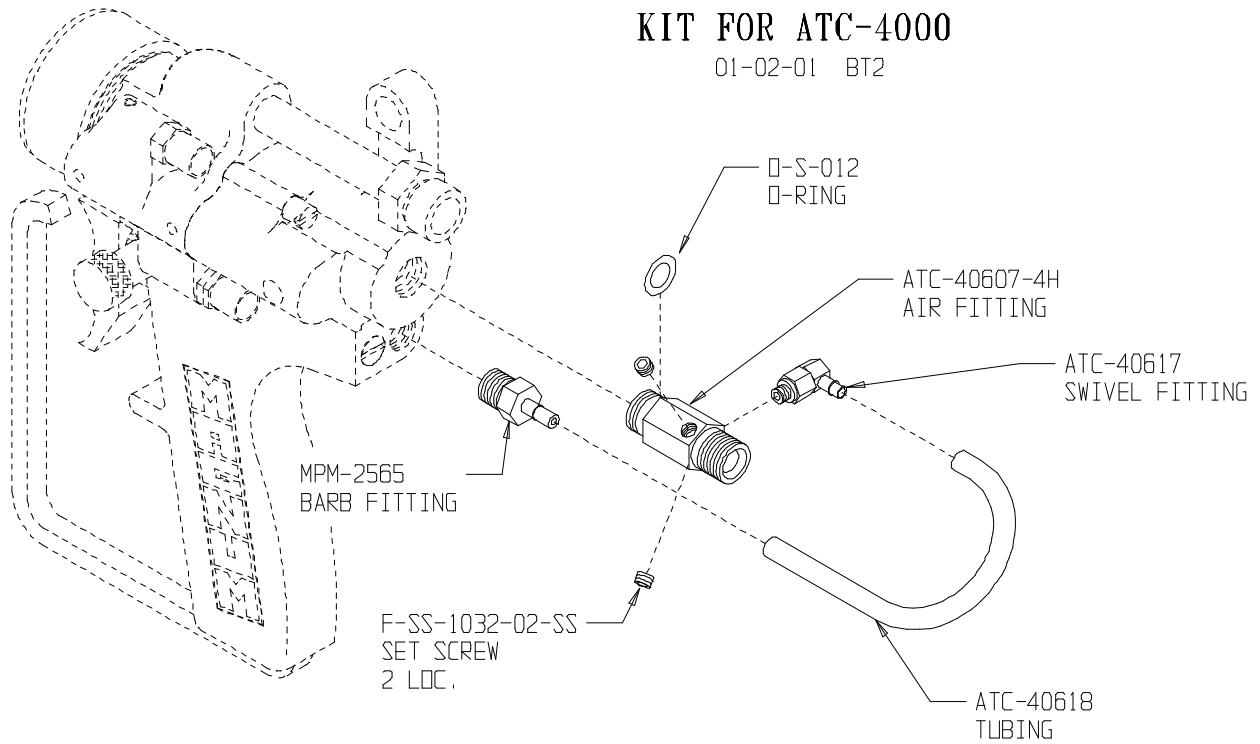

NOTE: INSTALL ATC-40607-4H TO DETERMINE WHERE THE OPEN TAPPED HOLES WILL BE. INSTALL THE ATC-40608 IN AN OPEN HOLE ON THE RIGHT SIDE. ITS POSITION WILL VARY. PLUG THE OTHER HOLES WITH THE SET SCREWS AND LOCTITE. DO NOT USE TUBING TO HANG GUN.