

▷ USE REMOVABLE LOCTITE ON THREADS OF ITEM 46
 ▷ INSTALL ITEM 18 WITH COUNTERBORE DOWN

▷ INSTALL ITEM 7 WITH FLANGE UP
 ▷ INSTALL ITEM 7 WITH FLANGE DOWN

MAGNUM VENUS PLASTECH

3-1/4" POWER HEAD ASSEMBLY

MPR-PH-3250

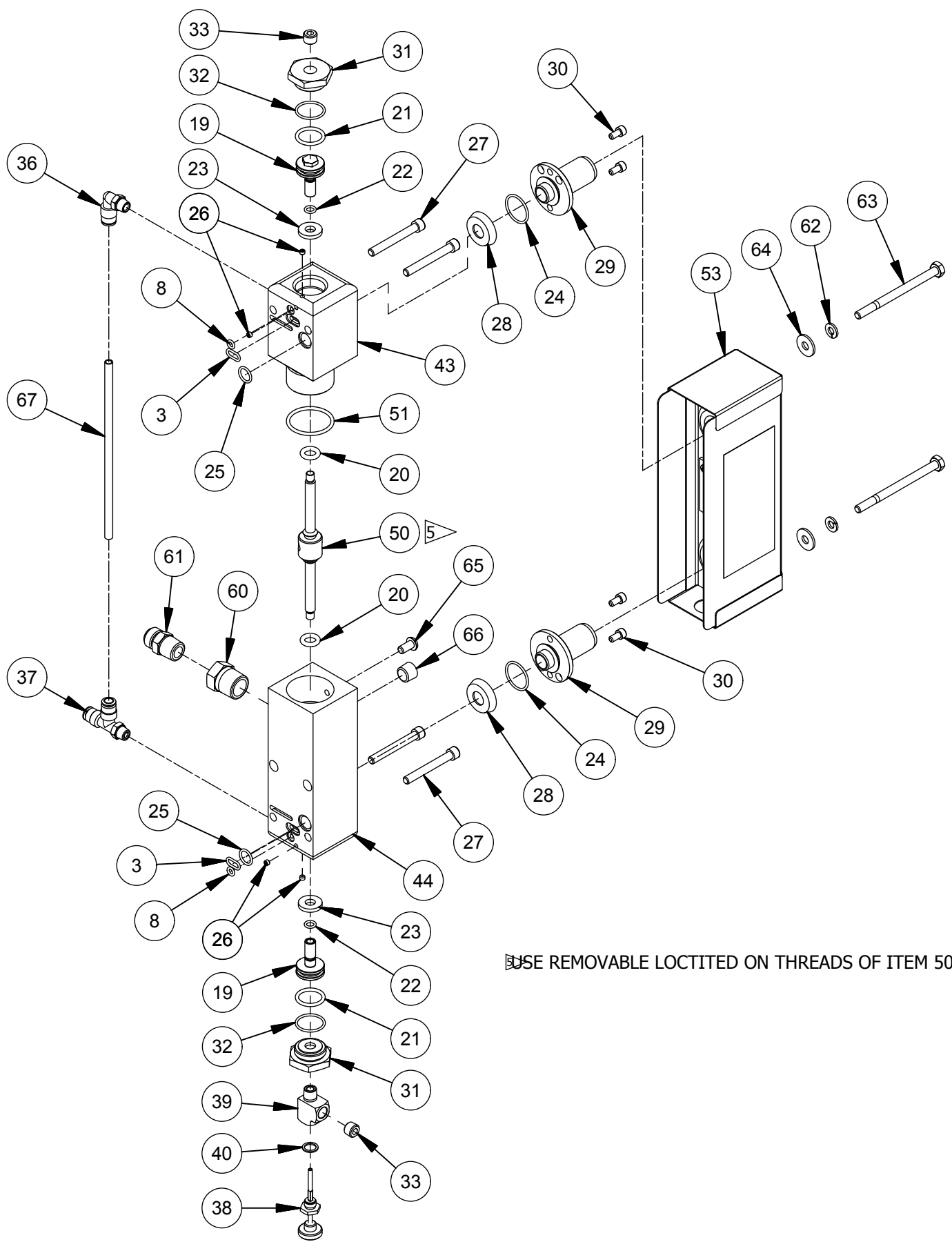

USE REMOVABLE LOCTITED ON THREADS OF ITEM 50

MAGNUM VENUS PLASTECH

3-1/4" POWER HEAD ASSEMBLY

MPR-PH-3250

Parts List				
ITEM	PART NUMBER	QTY	DESCRIPTION	
	1	MPH-2533	2	COMPRESSION SPRING
	2	MPH-2540	2	INLET ROD- PILOT VALVE
*	3	O-B-012	6	O-RING
	4	MPH-2528	2	SPRING
	5	MPH-2526	2	SPRING
	7	MPH-2512	2	SEAL GUIDE- PILOT VALVE
*	8	O-B-008	4	O-RING
	9	MPH-2513	2	VALVE STEM- PILOT VALVE
	10	MPH-2511-01	2	STEM SEAL ASSY- PILOT VALVE
	11	MPH-2541	1	SPRING HOUSING- PILOT VALVE
*	12	O-B-152	2	O-RING
	13	PAT-PH-3212	1	UPPER END CAP- 3-1/4"
	14	VPH-4254	2	BUSHING- 7/8 DIA. PISTON ROD
*	15	O-B-118	2	O-RING
*	16	O-B-121	2	O-RING
	17	MPH-3261	2	SNAP RING - EXTERNAL
	18	MPH-3251	1	PISTON - 3-1/4" POWER HEAD
	19	MPH-2517	2	VALVE PISTON
*	20	O-U-204-90	2	O-RING
*	21	O-B-116	2	O-RING
*	22	O-D-010-90	2	O-RING
	23	MPH-3262	2	PISTON STOP
*	24	O-B-020	2	O-RING
*	25	O-B-013	2	O-RING
	26	F-SS-832-02-SS	4	SS SET SCREW
	27	F-CS-04C-32	4	SOCKET HEAD CAP SCREW
*	28	MPH-2529	2	DIAPHRAGM
	29	MPH-2522	2	VALVE EXHAUST PORT
	30	F-CS-1024-06-SS	4	CAP SCREW
	31	MPH-2521	2	VALVE END CAP
*	32	O-B-019	2	O-RING
	33	PF-AP-02-SS	2	PIPE PLUG
*	34	O-B-404	2	O-RING
*	35	O-B-336	1	O RING
	36	MPH-2539	1	MALE ELBOW
	37	MPH-2538	1	MALE POLY TEE FITTING
	38	MPH-2546-01	1	RESET STEM ASSEMBLY
	39	PF-ST-02-BR	1	TEE FITTING
	40	MPH-2545	1	SEAL
*	41	MPH-3254	1	LOWER END CAP- 3-1/4" POWER HEAD
*	42	O-U-006	2	O-RING
	43	VPH-4257	1	UPPER VALVE BLOCK- 4" STROKE
	44	MPH-2516	1	LOWER VALVE BLOCK
	45	MPR-PH-5009-HR	1	LOWER PISTON ROD
	46	MPR-PH-5008	1	UPPER PISTON ROD
	47	VPH-3251	1	CYLINDER
	48	VPH-4258	3	TIE ROD- 4" STROKE POWER HEAD
	49	F-HN-05C	6	HEX NUT
*	50	VPH-2504	1	VALVE ROD POPPET
*	51	O-B-125	1	O-RING
	52	MLM-PD-4097	1	PISTON ROD CLEVIS
	53	VPH-4253	1	MUFFLER ASSEMBLY
	54	MPR-PH-5011	4	TIE ROD
	55	MPR-PH-5051	1	BASE PLATE
	56	MPR-PH-5052	1	SPRING HOUSING
	57	F-HB-06C-24	4	HEX BOLT
	58	F-SB-08-36	1	SHOULDER BOLT
	59	F-LN-06C	1	LOCK NUT
	60	PF-RB-08-06	1	BUSHING FITTING
	61	PF-HN-06-06S	1	HOSE ADAPTER
	62	F-SW-04-SS	2	LOCK WASHER
	63	F-HB-04C-56-SS	2	HEX BOLT
	64	F-FW-04	2	FLAT WASHER
	65	F-BHCS-04C-08-SS	1	BUTTON HEAD CAP SCREW
	66	PF-AP-04-SS	1	ALLEN PLUG
	67	MS-2052-1	.56 FT	POLY TUBE

OPTIONAL PARTS AND ASSEMBLIES
PARTS LIST

PART No.	QTY	DESCRIPTION
MPH-2542	1	RESET BUTTON ASSY

REPAIR KITS

PART No.	DESCRIPTION
* MPR-PH-3250-SK	SEAL KIT

* ASTERISKS DENOTE PARTS IN SEAL KIT

MAGNUM VENUS PLASTECH

3-1/4" POWER HEAD ASSEMBLY

MPR-PH-3250